



ASSEMBLY INSTRUCTION

Your experience means alot to us.

Thank you for choosing our product.

Please share your product experience if you are happy with it. Feel free to contact us on Amazon in case of any problem regarding assembling or the product itself.

Assembly Instruction

Part B assembly steps

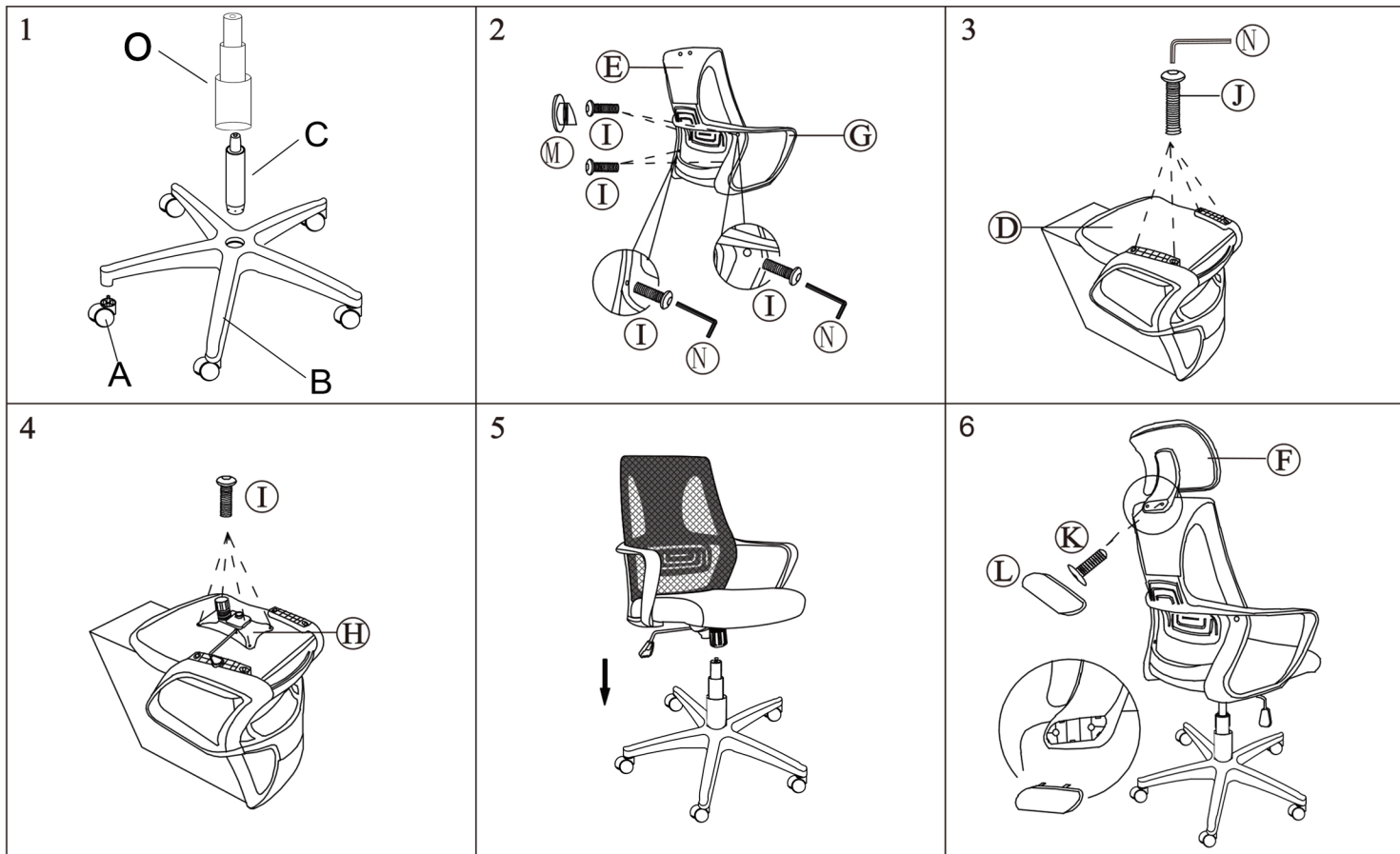

PART Pièce Pieza		Qty. Qte. Ctd.
A		5
B		1
C		1
D		1
E		1
F		1
G		1

PART Pièce Pieza		Qty. Qte. Ctd.
H		1
I		8
J		4
K		2
L		1
M		2
N		1
O		1

Important

1. Before you begin: Lay out all parts on a clean surface to check if the tags and numbers are correct.
2. Don't screw tightly before all the screws are put into the corresponding holes.
3. Please use the screws correctly, otherwise you might damage the desk panel.
4. It is recommended to install this desk by two people.

