

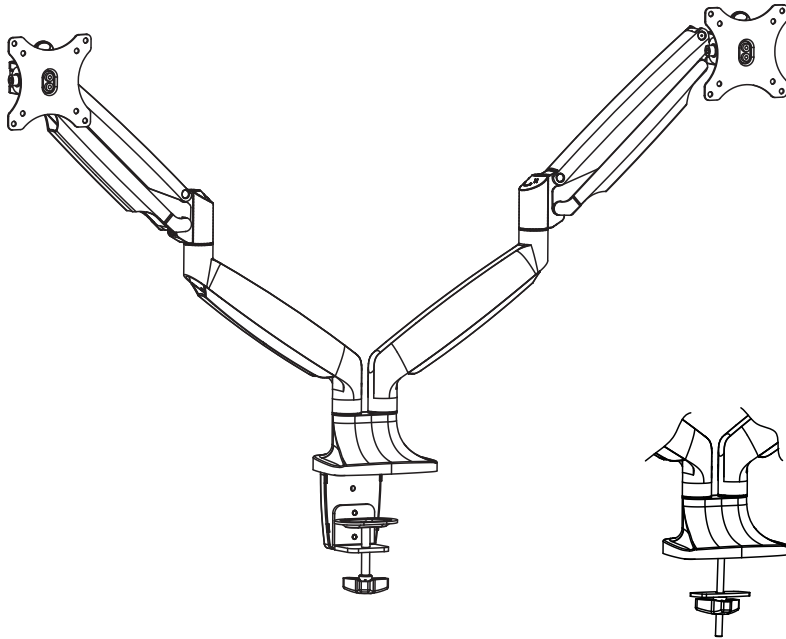

INSTALLATION MANUAL

Monitor Desk Mount



ELTGM03-2



75x75/100x100



www.eletabergo.com



service@eletabergo.com



www.facebook.com/EleTabus

 Read the entire instruction manual before you start installation and assembly. If you have any questions regarding any of the instructions or warnings, Please contact at  service@eletabergo.com for assistance.

CAUTION:

 Use with products heavier than the rated weights indicated may result in instability causing possible injury.

- Mounts must be attached as specified in assembly instructions. Improper installation may result in damage or serious personal injury.
- Safety gear and proper tools must be used. This product should only be installed by professionals.
- Make sure that the supporting surface will safely support the combined weight of the equipment and all attached hardware and components.
- Use the mounting screws provided and DO NOT OVER TIGHTEN mounting screws.
- This product contains small items that could be a choking hazard if swallowed. Keep these items away from children.
- This product is intended for indoor use only. Using this product outdoors could lead to product failure and personal injury.

IMPORTANT:

Ensure that you have received all parts according to the component checklist prior to installation. If any parts are received damaged or defective, please contact us at service@eletabergo.com. We are happy to replace parts to ensure you have a fully functioning product.

PRODUCT LINE GRAPH

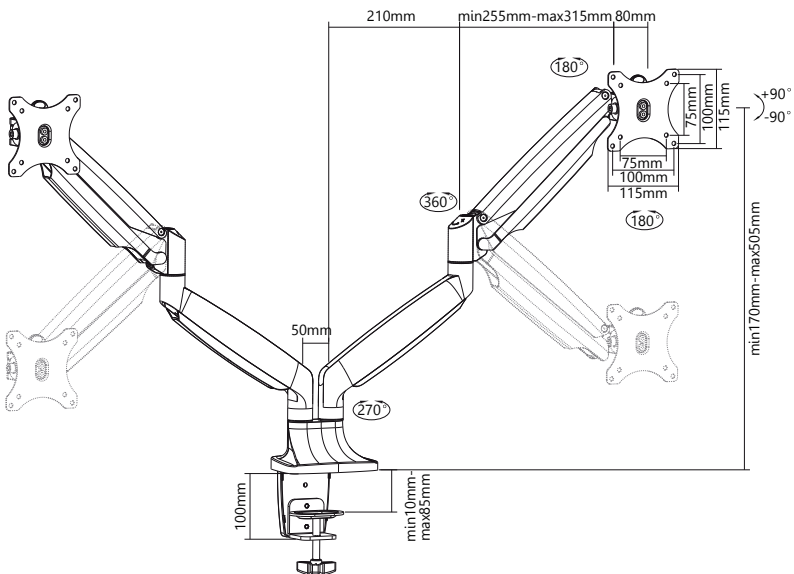

Parts

Tools required



L (x1)
4mm Allen
Wrench



M (x1)
6mm Allen
Wrench



Phillips
Screwdriver
(not included)

Components

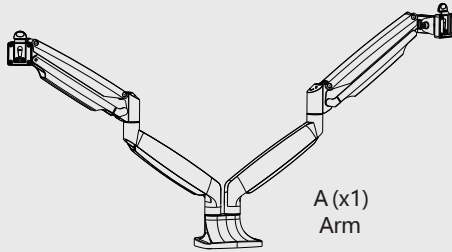

A (x1)
Arm



B (x2)
VESA Plate



C (x1)
Clamp Base
Support

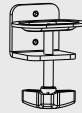

D (x1)
Clamp



E (x1)
Decorative
Cover



F (x1)
Long Screw



G (x5)
Bolt



H (x1)
Base Support



I (x1)
Support Plate



J (x1)
Knob



K (x4)
Pad

Hardware



M4x12mm (x4)
M-A
Screw



M5x12mm (x4)
M-B
Screw



D5 (x4)
M-C
Washer

X2

STEP 1 Attach the Arm to the Desk

OPTION A: Clamp Installation

Install clamp base support (C) onto base of the arm (A) with bolts (G) using provided 4mm Allen wrench (L). Apply pads (K) to the base.

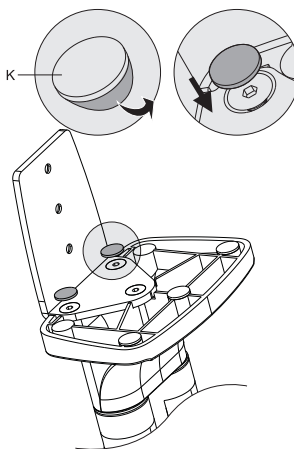
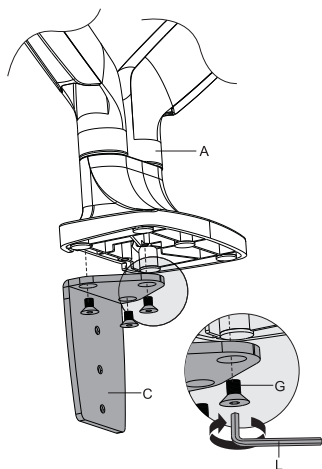

For the Desktop with Thickness of 10-55mm

Secure clamp (D) to upper two holes with bolts (G) using 4mm Allen wrench (L).

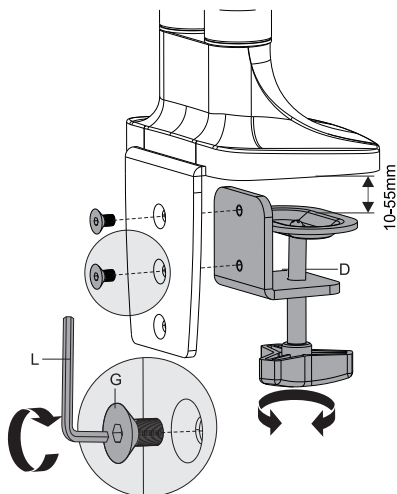

For the Desktop with Thickness of 50-85mm

Secure clamp (D) to lower two holes with bolts (G) using 4mm Allen wrench (L).

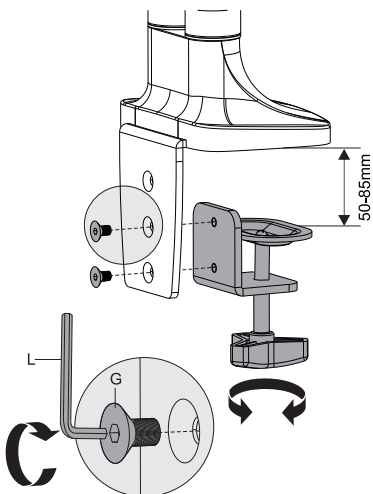

Attach the decorative cover (E) to the clamp base support. Fit clamp to the desk and turn the plastic knob counter-clockwise to tighten the connection.

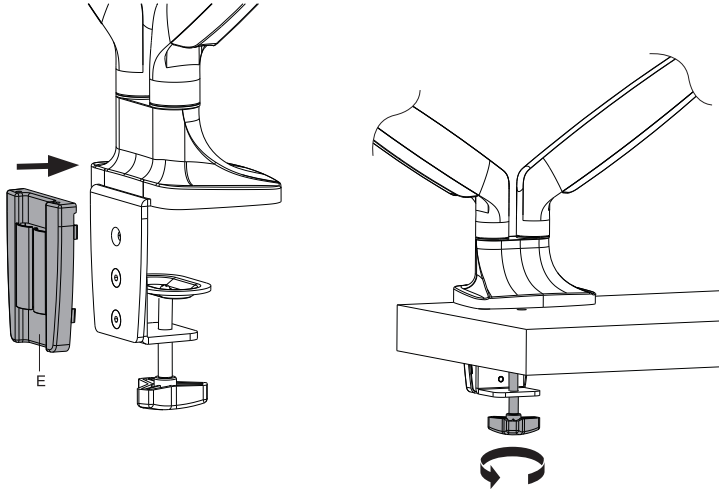

STEP 1 (Continued)

OPTION B: Grommet Base Installation

Assemble the base support (H) to the base with long screw (F) and bolts (G) using 4mm Allen wrench (L). Apply pads (K) to the base.

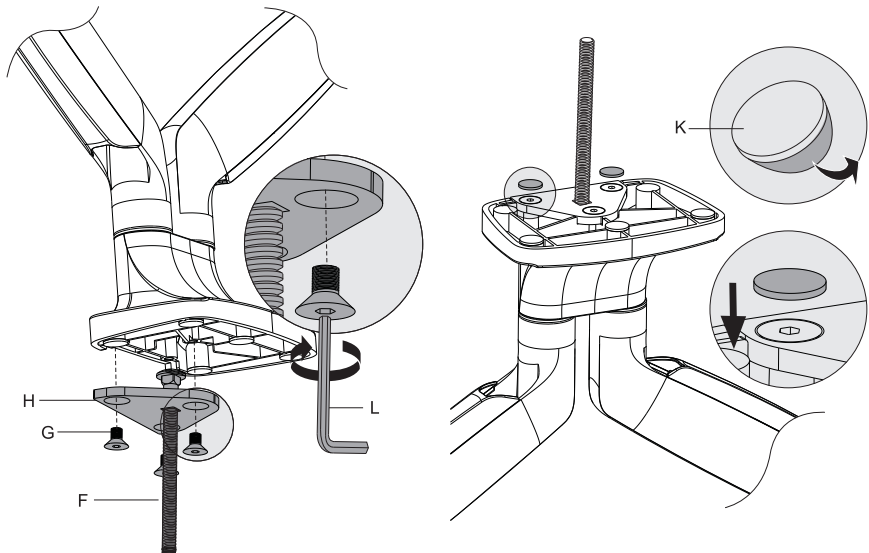

Insert the long screw through the hole on the desk and attach the base to the desk using the support plate (I) and the knob (J). Turn the knob counterclockwise to tighten the connection.

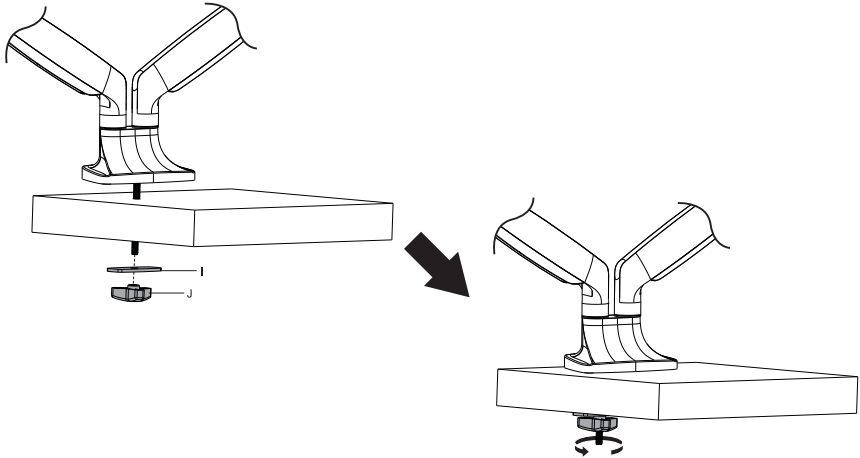

STEP 2 Attach the Monitors to the Arm

Attach VESA plate (B) to the monitor with washers (M-C) and screws (M-A) or (M-B)

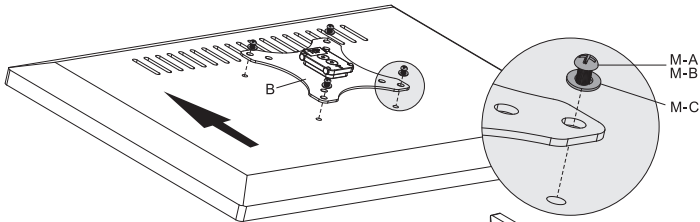
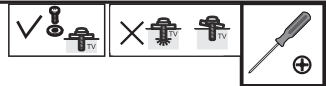

Pull the tab on the arm (A) ① and attach the monitor to the arm. ②

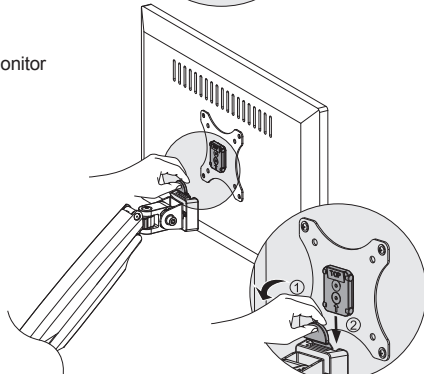

STEP 3 Adjust the Gas Spring Tension

Once the monitor is attached to the arm, use the 6mm Allen wrench(M) and turn in the appropriate direction to increase or decrease tension as necessary. Heavier monitor turns counter-clockwise. Lighter monitor turns clockwise. Adjust the tension of the gas spring until the monitor holds its position when you let it go. (Note: DO NOT overtighten screw.)

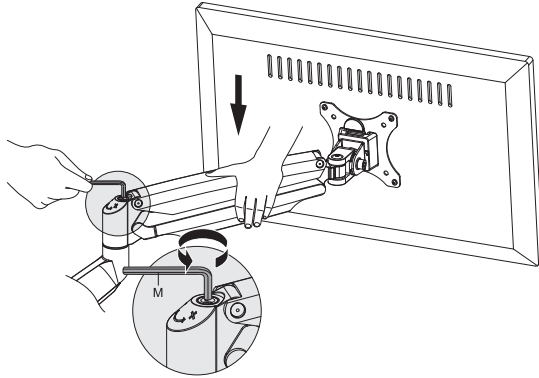

Be sure to keep the arm in horizontal position during adjustment. Or else it would be difficult to adjust the mount or damage the mount.

Case 1: Monitor/Arm Falls Down (After Install Your Monitor)

When the monitor is too heavy, turn the 6mm Allen wrench counter-clockwise to increase tension till it can hold the weight of your monitor.

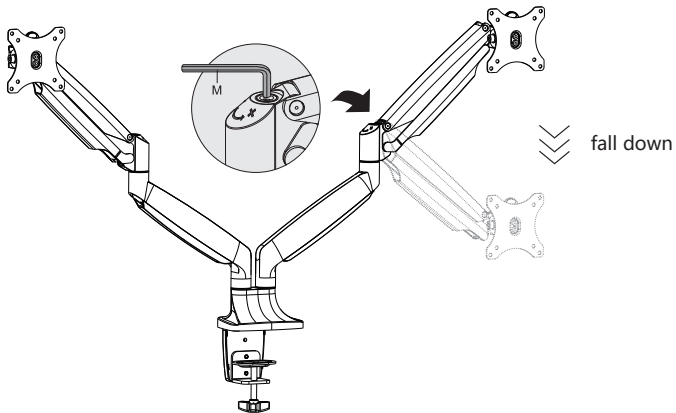

Case 2: Monitor/Arm Pops Up (After Install Your Monitor)

When the monitor is too light, turn the 6mm Allen wrench clockwise to decrease tension till the monitor can stay at the desired position.

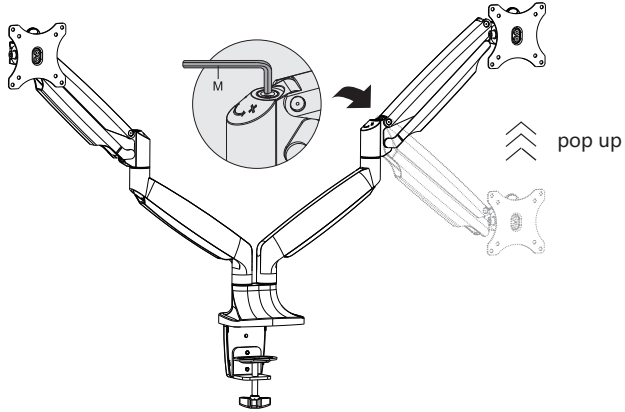

Case 3: Monitor Tilts Forward

If needed, tilt the monitor using the 6mm Allen wrench to your desired angle.

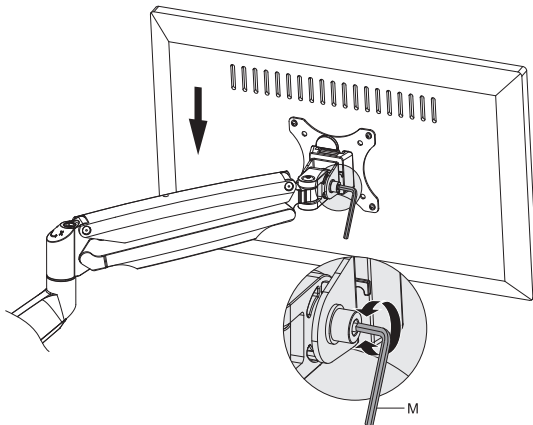

STEP 4 Cable Management

Remove the upper and bottom cable covers as shown.

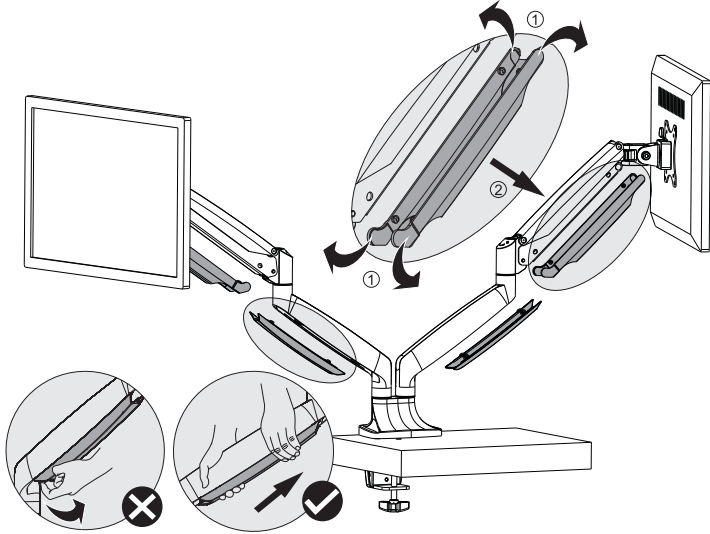

Route cable along the arm as shown and reattach the upper and bottom cable covers.

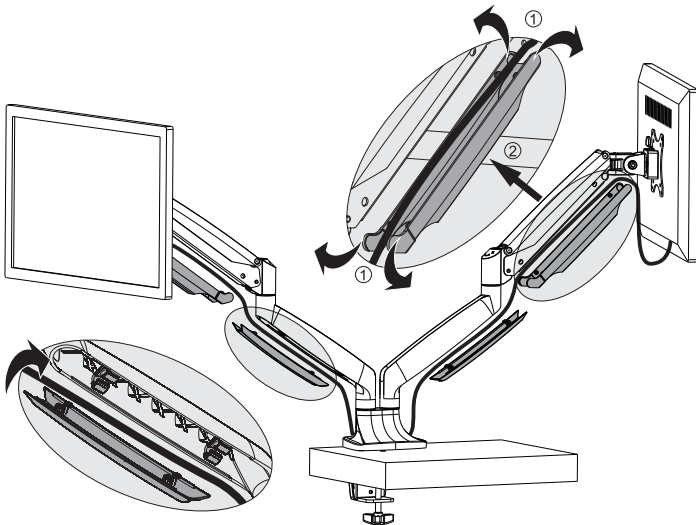

STEP 5 Insert the Allen Wrenches into the Slot

Adjust monitors to the desired position and insert Allen wrenches (L&M) into the slot.

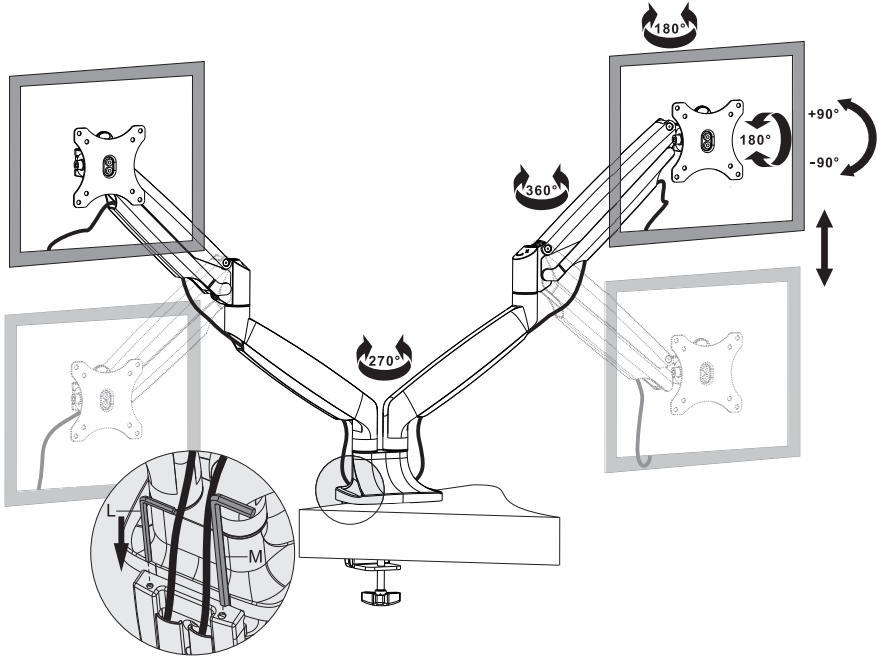

WARRANTY SERVICE

To provide the best service to you, do not forget to register your EleTab product to obtain 12 months extended warranty and lifetime after-sales service.



Feedback

Love it? Hate it?

Let us know with a customer review.

EleTab is committed to delivering customer-driven products that live up to your high standards. We encourage you to write a review sharing your experience.

Should you have any issues, please don't hesitate to contact us.



Scan the QR code above to join our Facebook group

For further services:



www.eletabergo.com



service@eletabergo.com



www.facebook.com/ElеTabus